

PLAT OF SURVEY

SURVEYOR'S CERTIFICATE

I, JAMES K. LANGONE, REGISTERED LAND SURVEYOR, CERTIFY THAT I HAVE SURVEYED THE PROPERTY DESCRIBED BELOW AND THAT THE PLAT SHOWN HEREON IS A CORRECT REPRESENTATION OF THE BOUNDARIES.

DATE: 7/21/95

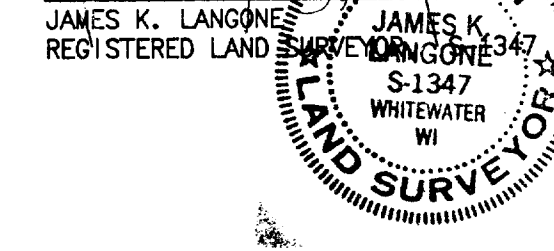

LEGAL DESCRIPTION

The following described real estate located in Section 3, T4N, R15E, City of Whitewater, Walworth County, Wisconsin, to-wit:

A part of the South 1/2 of Sec. 3, T. 4 N., R. 15 E. and bounded as follows: Beginning in the center of Milwaukee Street 15 rods East of the North and South 1/4 line of said Section 3, and running thence South 70° West along the center of said street to a point intersected by the center of Elkhorn Street or Road, thence Southerly along the center of Elkhorn Street or Road, 23 chains and 83 links, thence E. 38 links to a point 15 rods East of said 1/4 line, thence North and parallel with the said 1/4 line to the place of beginning, excepting and reserving therefrom about 5-1/4 acres from the Southerly side thereof heretofore sold and conveyed to George Wooster, the North line thereof being parallel with the South line of said Section, all in the County of Walworth, State of Wisconsin.

Excepting and reserving from the above the following transfers: (1) Warranty Deed from Marion Jacobs and Minerva Jacobs, his wife, to James H. Crumney recorded in Volume 360 of Deeds on page 91. (2) Warranty Deed from Marion D. Jacobs and Minerva Jacobs, his wife, to Lance Simes and Frances Simes, his wife as joint tenants, deed recorded in Volume 438 of Deeds on Page 73. (3) Warranty Deed from Marion Jacobs and Minerva Jacobs, his wife, to Peter Schilt and Norma L. Schilt, his wife, as joint tenants, deed recorded in Volume 442 of Deeds on page 225. (4) Warranty Deed from Marion D. Jacobs and Minerva Jacobs, his wife, to John C. Parker, Sr., recorded in Volume 489 of Deeds, Page 179. (5) Warranty Deed from Marion D. Jacobs and Minerva Jacobs, his wife, to Edwin Sobolewski and Amelia Sobolewski, his wife as joint tenants, recorded in Volume 520 of Deeds, page 343. (6) Land Contract from Marion D. Jacobs and Minerva Jacobs, husband and wife, to Mary H. Bray and Daniel James Bray as joint tenants, which contract is recorded in Volume 415 of Mortgages on page 250. (Except also deed to Donald J. and Harriet Jacobs recorded Vol. 613 page 163).

Further excepting therefrom the parcel described in Quit Claim Deed from Clara Hamilton to Jean A. Webb dated November 21, 1986 and recorded in the office of the Register of Deeds for Walworth County, Wisconsin on November 24, 1986 in Volume 385 of Records at Page 337 as Document No. 138177 and the parcel of land described in the Warranty Deed from Clara Hamilton to Donald F. Piazza and Mary M. Piazza, husband and wife, dated January 15, 1993 and recorded in the office of the Register of Deeds for Walworth County, Wisconsin on February 2, 1993 in Volume 610 of Records at Page 661 as Document No. 250893. Further excepting therefrom Certified Survey Map No. 2599 according to the recorded Plat thereof recorded in Volume 13 of Certified Surveys on page 99 as Document No. 308413.

The above described real estate being also more particularly described as follows, to-wit: real estate located in the South 1/2 of Section 3, T4N, R15E, and lying and being in the City of Whitewater, Walworth County, Wisconsin, to-wit:

Commencing at the S 1/4 corner, Section 3, T4N, R15E, Walworth County, Wisconsin; thence N 3° 08' 18" W, along the North/South center section line, 687.59 feet, to a point on the northerly line of that certain parcel of land described in a Quit Claim Deed recorded in Volume 385 of Records on page 337 (said parcel being here-in-after referred to as the Webb parcel), said point being marked by a 1" iron pipe, said point also being the NE ly corner of CSM 1557, said point also being the "POINT OF BEGINNING"; thence N 75° 31' 28" E, along the northerly line of said Webb parcel, 252.43 feet, to a point on a line which is parallel to and 247.50 feet east of said North/South center section line, said point being marked by a 1" iron pipe; thence N 3° 08' 18" W, along said parallel line, 717.14 feet, to the SE corner of that certain parcel of land described in a Warranty Deed recorded in Volume 438 of Deeds on page 73 (said parcel being here-in-after referred to as the Simes parcel), said point being 135.00 feet southerly of the centerline of E. Milwaukee Street; thence S 74° 09' 06" W, along the southerly line of said Simes parcel, 113.26 feet (recorded 90 feet) to the SW corner of said Simes parcel; thence N 3° 08' 18" W, along the west line of said Simes parcel, 128.00 feet, to a point on the centerline of East Milwaukee Street, said point being the NW corner of said Simes parcel; thence S 70° 44' 49" W, along said street centerline, 10.00 feet, to the NE corner of that certain parcel of land described in a Warranty Deed recorded in Volume 442 of Deeds on page 225 (said parcel being here-in-after referred to as the Schilt parcel); thence S 3° 08' 18" E, along the east line of said Schilt parcel, 128.00 feet, to the SE corner of said Schilt parcel; thence S 69° 55' 16" W, along the southerly line of said Schilt parcel, 133.19 feet (recorded as 143 feet), to the SW corner of said Schilt parcel, said point being on the North/South center section line, Section 3, at a distance of 130.00 feet south of the centerline of East Milwaukee Street; thence N 3° 08' 18" W, along said North/South center section line, 9.00 feet, to the SE corner of that certain parcel of land described in a Land Contract recorded in Volume 415 of Mortgages on Page 250 (said parcel being here-in-after referred to as the Bray parcel); thence S 72° 27' 07" W, along the southerly line of said Bray parcel, 65.00 feet, to the SW corner of said Bray parcel, said point being on the east line of that certain parcel of land described in a Warranty Deed recorded in Volume 613 of Deeds on page 163 (said parcel being here-in-after referred to as the Jacobs parcel); thence S 12° 59' 05" E, along the easterly line of said Jacobs parcel, 8.00 feet, to the SE corner of said Jacobs parcel; thence S 70° 44' 49" W, along the southerly line of said Jacobs parcel, 129.00 feet, to the SW corner of said Jacobs parcel; thence N 12° 59' 05" W, along the westerly line of the Jacobs parcel, 123.00 feet, to the NW corner of said Jacobs parcel, said point being on the centerline of East Milwaukee Street; thence S 70° 44' 49" W, along said centerline, 60.15 feet, to the NE corner of that certain parcel of land described in a Warranty Deed recorded in Volume 520 of Deeds on page 343 (said parcel being here-in-after referred to as the Sobolewski parcel); thence S 9° 05' 36" E, along the easterly line of said Sobolewski parcel, 123.13 feet, to a 1" iron pipe marking the SE corner of said Sobolewski parcel, said point also being the NE corner of that certain parcel of land described in a Warranty Deed recorded in Volume 610 of Records on Page 661 (said parcel being here-in-after referred to as the Piazza parcel); thence S 11° 50' 51" E, along the easterly line of said Piazza parcel, 340.52 feet, to a 1" iron pipe marking the SE corner of said Piazza parcel, said point also being on the northerly line of Certified Survey Map No. 2599 as recorded in Volume 13 of Certified Surveys on page 99 as Document No. 308413; thence N 86° 51' 42" E, along the northerly line of said Certified Survey Map No. 2599, 200.01 feet to a 1" iron pipe marking the NE corner of said Certified Survey Map No. 2599, said point being on the north/south center section line of said Section 3; thence S 3° 08' 18" E, along the easterly line of said Certified Survey Map No. 2599, 294.83 feet, to the "POINT OF BEGINNING".

NOTES

- - INDICATES SET 3/4" IRON ROD
- - INDICATES RECORD DATA
- - INDICATES FD. 6" X 6" CONC. MONUMENT
- - INDICATES FD. 1" IRON PIPE UNLESS OTHERWISE NOTED

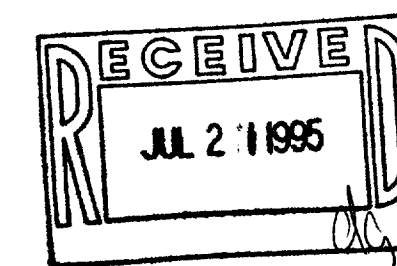
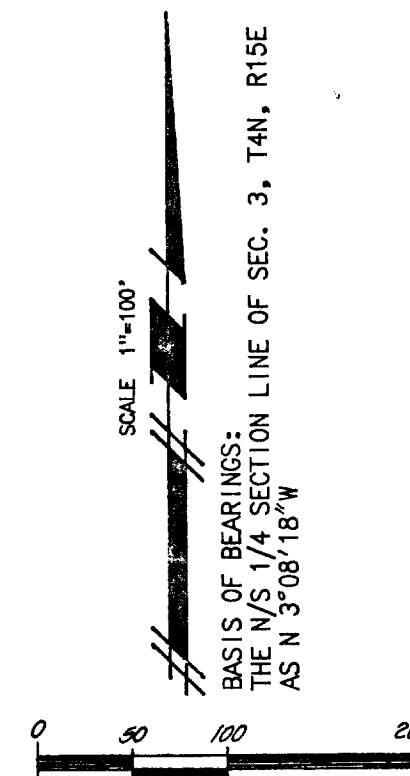

JAMES K. LANGONE LAND SURVEYS & CIVIL ENGINEERING			
N339 Co. Rd. N (Upper) Whitewater, WI. 53190-2842		(414) 473-4119	
SCALE: AS NOTED	APPROVED BY:	DRAWN BY: JL	
DATE:		REVISED:	
		DRAWING NUMBER: 95-100	

10-545